

Ingranaggi di ricambio adattabili per quadri strumenti meccanici

Replacement gears adaptable to mechanical dashboards

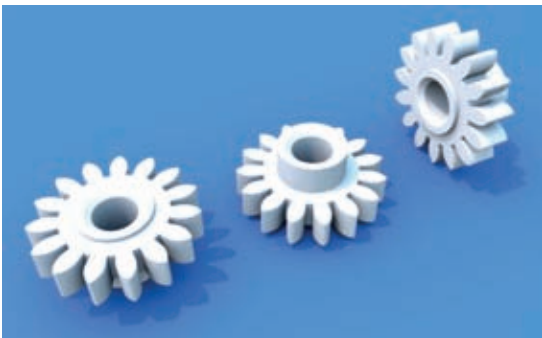

SEP-R01



SEP-R02

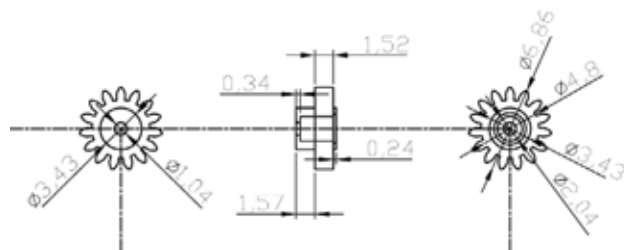
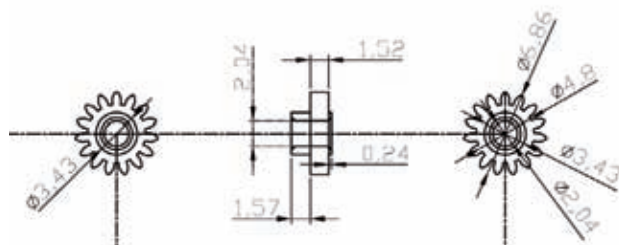

SEP-R01 / SEP-R02
(15 denti / 15 teeth)

Audi V8 / Audi 80-90 100 / Volvo 850 1ª Serie / Volvo 480 /
Mercedes S / Porsche 993 (Ultime versioni/[Latest models](#))



SEP-R03

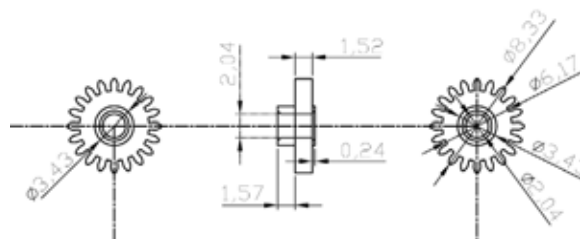

SEP-R04

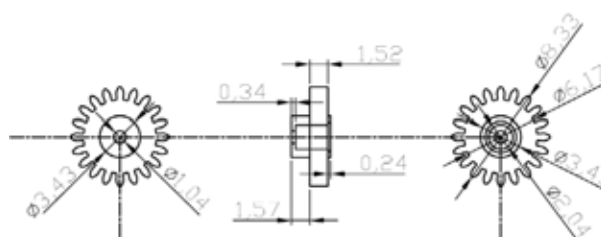

SEP-R03 / SEP-R04
(20 denti / 20 teeth)

Ford Scorpio / Volvo 850 2^a versione / Volvo 960 / Volvo 440



SEP-R05

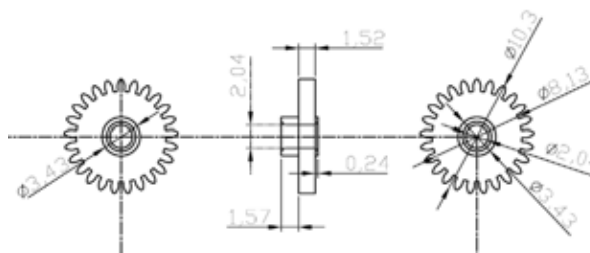

SEP-R06

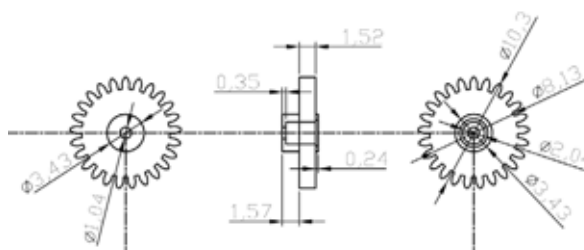

SEP-R05 / SEP-R06
(25 denti / 25 teeth)

Alfa Romeo 164 / Opel Omega B / Renault 25 (2^a serie)



SEP-R07

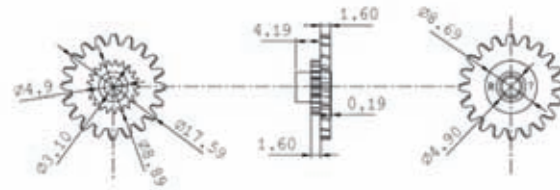

SEP-R07
(20 denti esterni - 21 interni / 20 external teeth - 21 internal)
 Porsche



SEP-R08

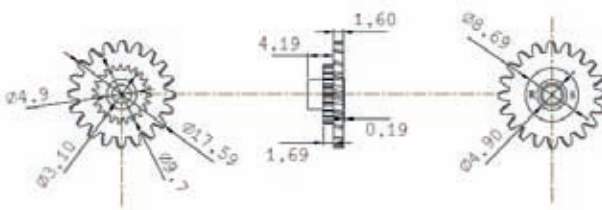

SEP-R08
(20 denti esterni - 23 interni / 20 external teeth - 23 internal)
 Porsche



SEP-R09

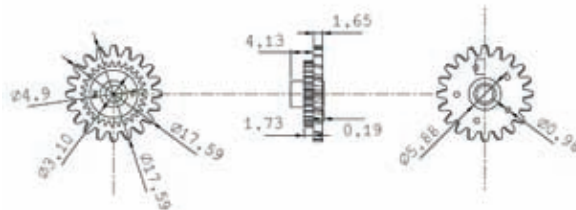

SEP-R09
(20 denti esterni - 29 interni / 20 external teeth - 29 internal)
 Rolls Royce / Lamborghini / Trattori VDO/VDO tractors



SEP-R10



SEP-R10
(20 denti esterni - 30 interni / 20 external teeth - 30 internal)
 Trattori Marine VDO/Marine VDO tractors



SEP-R11

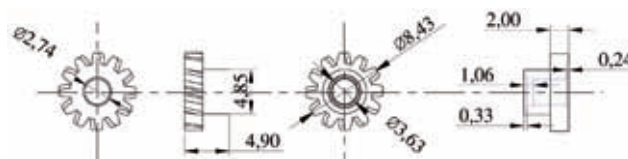

SEP-R11
(12 denti / 12 teeth)
Volkswagen VW Type 1
 comunemente conosciuto come **Maggiolone**
(also known as: Beetle, Käfer, Vocho or Fusca)



SEP-R12

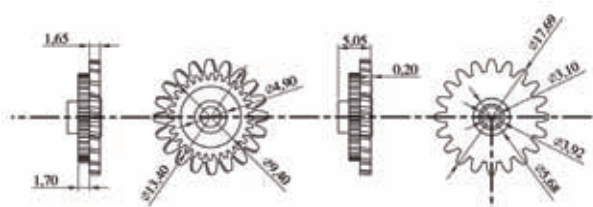

SEP-R12
(20 denti esterni - 32 interni / 20 external teeth - 32 internal)
 Porsche



SEP-R13

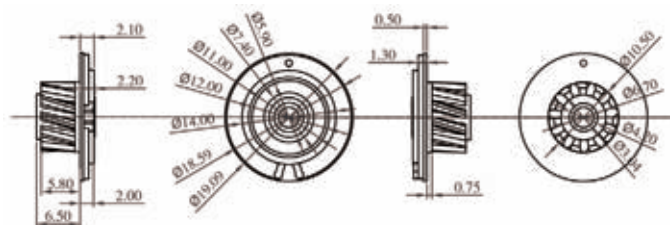

SEP-R13
(11 denti / 11 teeth)
 Opel Kadett

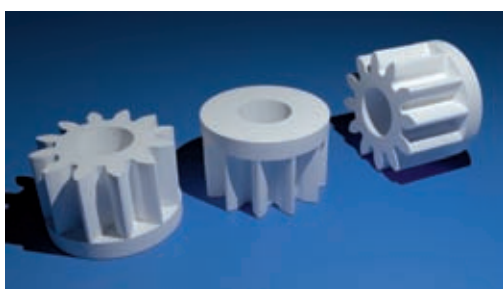

SEP-R14

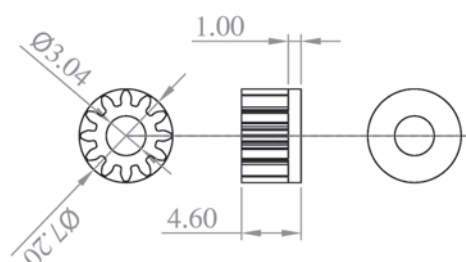

SEP-R14
(12 denti / 12 teeth)
 BMW 5.25



SEP-R15

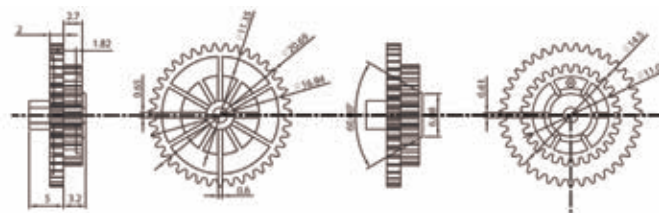

SEP-R15
(39 denti esterni - 28 interni / 39 external teeth - 28 internal)
BMW 5.20



SEP-R16

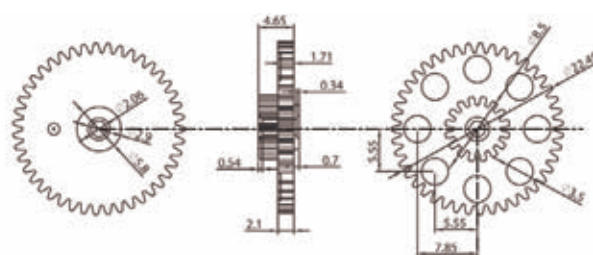

SEP-R16
(43 denti esterni - 16 interni / 43 external teeth - 16 internal)
BMW 5.20



SEP-R17

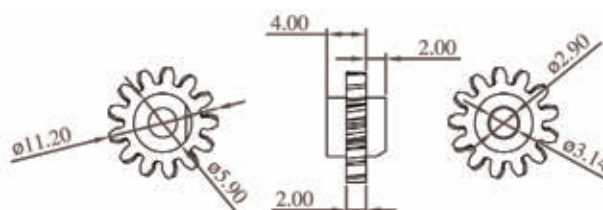

SEP-R17
(13 denti / 13 teeth)
Mercedes (versioni precedenti alla 124/Models before the 124) /
Audi (fino al 1988/Until 1988) / Volkswagen Golf 1



SEP-R18

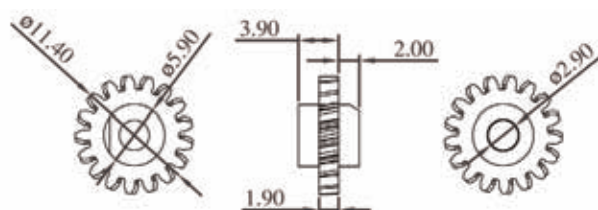

SEP-R18
(17 denti / 17 teeth)
Mercedes 124 / Audi 80-100 / Volkswagen Golf 2 / Volvo VDO



SEP-R19

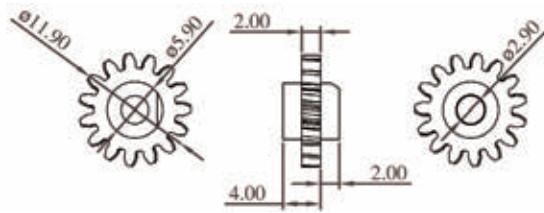

SEP-R19

(15 denti / 15 teeth)

Mercedes (versioni precedenti alla 124/[Models before the 124](#)) / Audi (fino al 1988/[Until 1988](#)) / Volkswagen Golf 1



SEP-R20

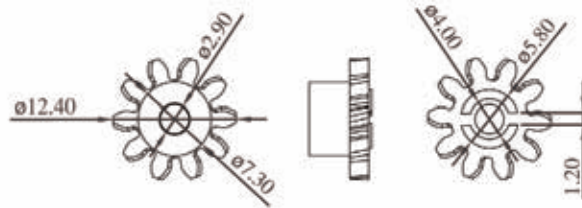

SEP-R20

(10 denti / 10 teeth)

Mercedes (versioni precedenti alla 124/[Models before the 124](#)) / Audi (fino al 1988/[Until 1988](#)) / Volkswagen Golf 1



SEP-R21

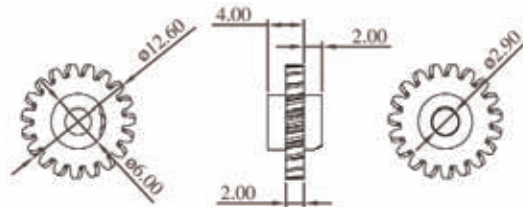

SEP-R21

(19 denti / 19 teeth)

Mercedes 124 / Audi 80-100 / Volkswagen Golf 2 / Volvo VDO



SEP-R22

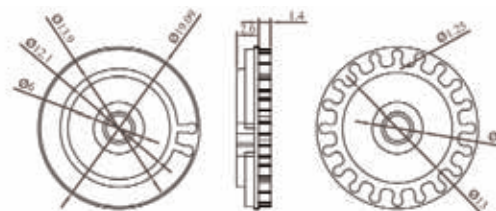

SEP-R22

(20 denti / 20 teeth)

Mercedes 124 / Audi / Volkswagen VDO



SEP-R23

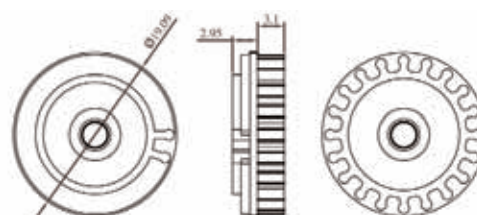

SEP-R23
(20 denti / 20 teeth)
Audi / Volkswagen / Mercedes / Volvo



SEP-R24

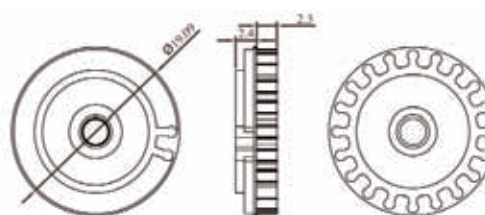

SEP-R24
(20 denti / 20 teeth)
Audi / Mercedes / Volkswagen Motometer / Volvo



SEP-R25

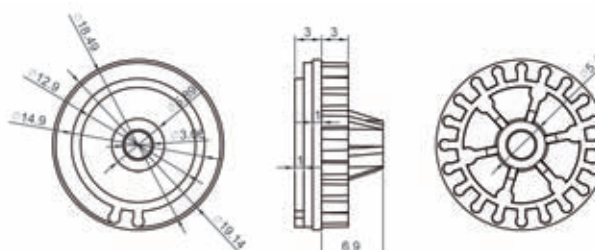

SEP-R25
(20 denti / 20 teeth)
Mercedes



SEP-R26

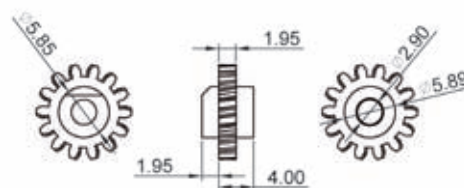

SEP-R26
(14 denti / 14 teeth)
Audi 80 / Audi 100 / Volvo 850 / Mercedes Serie S



SEP-R27

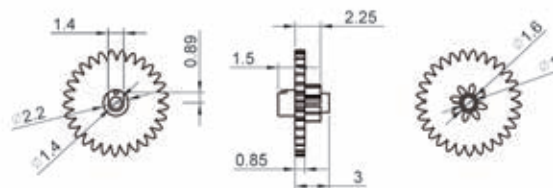

SEP-R27
(29 denti esterni - 8 interni / 29 external teeth - 8 internal)

Utilizzabile come ricambio per la riparazione dei motorini per contachilometri Volkswagen, Audi, Seat e Skoda (91 255 002/005/006/007/008/112) / Usable as spare part to repair the stepper motors for Volkswagen, Audi, Seat and Skoda speedometers (91 255 002/005/006/007/008/112)



Articolo correlato / Related article:
 SEI-MOT08



Minitools è un marchio di
 Savi Elettronica Srl - Società Unipersonale
 Contrada Popoieto 14B - 70011 Alberobello (BA) - Italy
 Tel (+39) 080 4324023 / (+39) 080 2221223
 Fax (+39) 080 4327154 / (+39) 080 2221224
 info@minitools.it
 C.F. / P.IVA / N.I. Reg.Imp.Bari 05948750723 - Capitale sociale € 20.000,00 I.V.

I contenuti del presente documento (testi, grafica, foto) sono di proprietà di Savi Elettronica Srl e sono protetti dalle leggi italiane ed internazionali sul copyright. E' consentita l'archiviazione e la stampa solo a scopo personale. E' vietato qualsiasi altro utilizzo (didattico, commerciale, ecc.) dei contenuti del presente documento da parte di terzi, senza il preventivo consenso scritto del titolare.

Tutti i marchi citati in questo documento sono di proprietà dei rispettivi proprietari e sono usati esclusivamente per l'identificazione o la descrizione di beni e servizi.

The contents of this document (texts, graphics, photographs) are property of Savi Elettronica Srl and are protected by italian and international copyright laws. Copy and reproduction is granted only for personal use. Any other use (commercial, didactic, etc) it's forbidden and must be previously approved by the author. Original P/n and makes for indicative purpose only.